

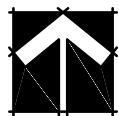

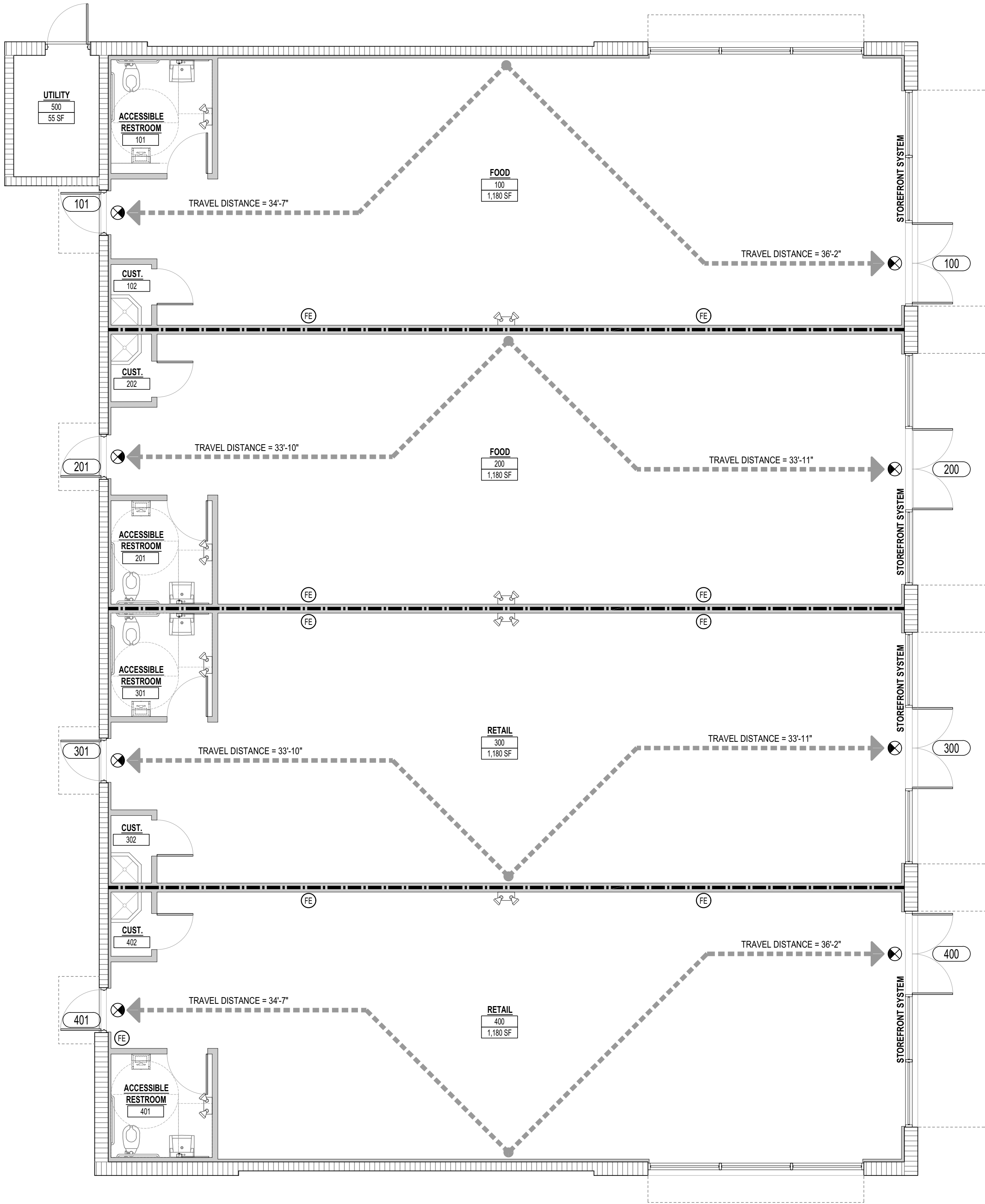

Drawing name: P:\2023 Projects\2304 - 4791 N Fed Hwy Pompano\ARCH1012 - 2304_LS-101 - LIFE SAFETY PLAN.dwg Layout1 Jan 09, 2024 3:50pm by bhayles



1

LIFE SAFETY PLAN

SCALE: 3/16" = 1'-0"

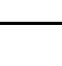
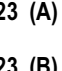
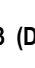
LIFE SAFETY PLAN LEGEND			
	PRIMARY MEANS OF EGRESS		
	(1) HR. FIRE RATED TENANT SEPARATION WALL		
	METAL STUD / GYPSUM W.B. PARTITION		
	STOREFRONT GLASS / WINDOWS		
	CEILING MOUNTED EXIT LIGHT FIXTURE		
	WALL MOUNTED EMERGENCY LIGHT FIXTURE		
	10 LB. 4A:80B°C FIRE EXTINGUISHER - SURFACE MOUNTED WITH WALL BRACKET		
APPLICABLE CODES			
2023 (A)	FLORIDA BUILDING CODE - BUILDING, 8TH EDITION		
2023 (B)	FLORIDA BUILDING CODE - EXISTING, 8TH EDITION		
2023 (C)	FLORIDA BUILDING CODE - ACCESSIBILITY, 8TH EDITION		
2023 (D)	FLORIDA BUILDING CODE - PLUMBING, 8TH EDITION		
2023 (E)	FLORIDA BUILDING CODE - ENERGY, 8TH EDITION		
2023 (F)	FLORIDA FIRE PREVENTION CODE, 8TH EDITION		
2023 (G)	FLORIDA FIRE PREVENTION CODE - LIFE SAFETY, 8TH EDITION		
2023 (H)	FLORIDA BUILDING CODE - MECHANICAL, 8TH EDITION		
2023 (J)	NATIONAL ELECTRIC CODE, 2023 EDITION		
2023 (I)	NFPA 101 - LIFE SAFETY CODE, 2023 EDITION		
USE AND OCCUPANCY CLASSIFICATION (A) SECTION 311.3			
PRIMARY OCCUPANCY : GROUP 'B' BUSINESS			
TABLE 601: TYPE OF CONSTRUCTION : 'N' (NON - SPRINKLER)			
MAXIMUM COMMON PATH OF EGRESS TRAVEL DISTANCE (A) TABLE 1017.2 'B' 200' (WITHOUT SPRINKLER SYSTEM) MAXIMUM TRAVEL DISTANCE = 200 FEET			
MEANS OF EGRESS - (A) SECTION 100.3.2			
EXIT	EGRESS CAPACITY FACTOR (INCHES / PERSON)	EGRESS WIDTH (INCHES)	EGRESS CAPACITY (PERSON)
100	0.2 FOR DOORS	72"	360
101	0.2 FOR DOORS	36"	180
200	0.2 FOR DOORS	72"	360
201	0.2 FOR DOORS	36"	180
300	0.2 FOR DOORS	72"	360
301	0.2 FOR DOORS	36"	180
400	0.2 FOR DOORS	72"	360
401	0.2 FOR DOORS	36"	180

JUSTIN ARCHITECTS
JUSTINARC.COM
2400 E. COMMERCIAL BLVD.
STE 201, FT LAUDERDALE,
FLORIDA 33308
954-771-2724

Digitally signed by Juan C Justiniano
Date: 2024.01.16 15:16:43-05'00'

SEAL:

PROJECT: RETAIL DEVELOPMENT
4791 N. FEDERAL HIGHWAY
POMPAÑO BEACH, FLORIDA

DATE: 01/03/2024
DRAWN BY: BH
CHECKED BY: CJ
JOB No: 2304

REVISIONS:

LIFE SAFETY PLAN
SHEET: LS-101

SITE PLAN REVIEW SUBMITTAL

PZ23-12000049
02/21/2024